



Scan the QR code to discover more & receive a quotation!

VebaBox
Cold Chain Innovators

STANDARD LINE MODEL Q COOL

SPECIFICATIONS

	Width	H1	H2	H3	Depth
Box volume (in L)		3566	3835	4103	
External dimensions (wxhxd, in mm)	1380	1500	1600	1700	2350
Inside dimensions (wxhxd, in mm)*	1224	1394	1494	1594	2194
Nett. weight		214 kg	224 kg	234 kg	
Temperature setting range	2°C to 25°C				
Ambient temperature	-20°C to +40°C				
Equipped with Thermal Unit	TUC6000				
Power source, max. power draw @ 12V	80 A @12V				
Power source, max. current @ 110~230V AC (50/60Hz)	7.8 A @ 230V				
Wall thickness	50 mm				

This VebaBox is fitted as standard with a Side door and ALU floor. A VebaBox includes: Thermal unit, installation set, 12V Power cable and 110 / 230V shore power connection.
* Dimensions until thermal unit.

DIMENSIONS IN MM

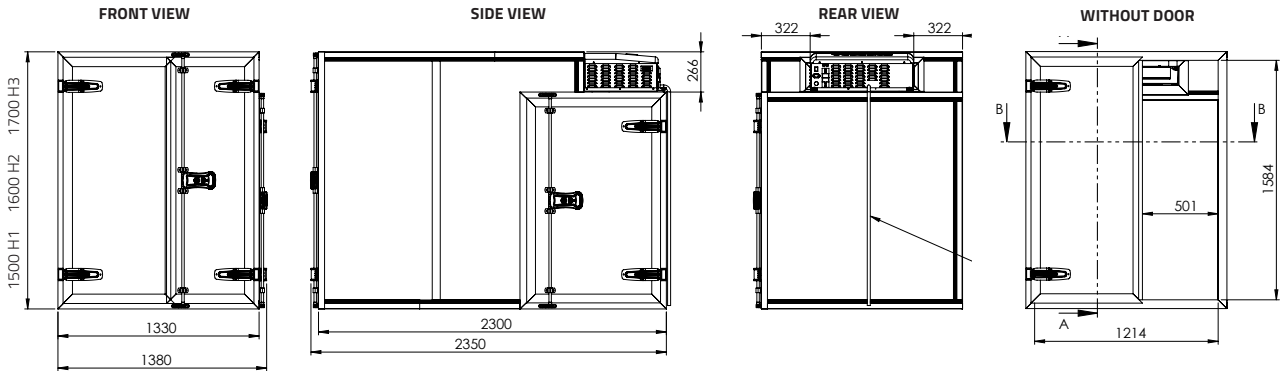

COOLING AND HEATING PERFORMANCES

Cooling performance at ambient temperature Model Q Cool

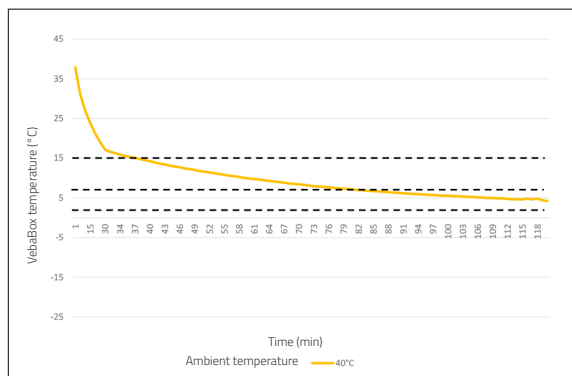

Heating performance at ambient temperature Model Q Cool

